



Silvenia

# About Us

Associated Recons started in 2014 as a modest yet strong, consistent, multi-faceted, multi-disciplinary organization, committed to customer satisfaction.

We have always banked on innovation, teamwork, high degree of technical expertise and maintaining the highest standards of business practice.

Some highlights of our organization

- An enviable track record of on-time delivery of projects.
- An experienced technical team comprising of experienced civil engineers, architects, finance and legal experts.
- Survived and delivered projects in Covid times and are here to stay with 7 projects already in pipeline in good locations like Dahanukar Colony, Karvenagar, Mayur colony, Law College Road.
- An collective experience of more than 100+ years.
- We are also experts in Green Building, Our last project 'SAROJ' was awarded the 'PLATINUM' rating by the IGBC, India.

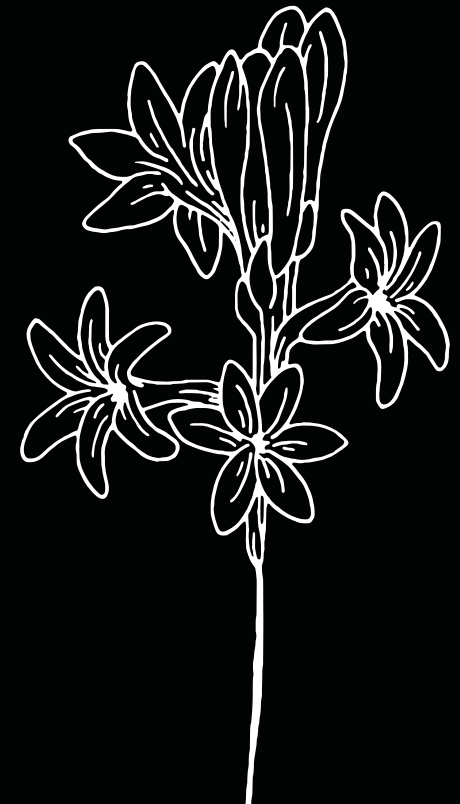

# The Architecture

Taking your comfort to new  
HEIGHTS

## HIGHLIGHTS

Location | 1st Tower in Dahanukar



# The Apartments

Maximum efficiency of space and attention to minute details will make your life a little more comfortable.

Each flat comes with attached balconies, windows designed for ample sunlight, quality fittings and room sizes that fits your budget.

## HIGHLIGHTS

Smart elevation | Smart floor plans

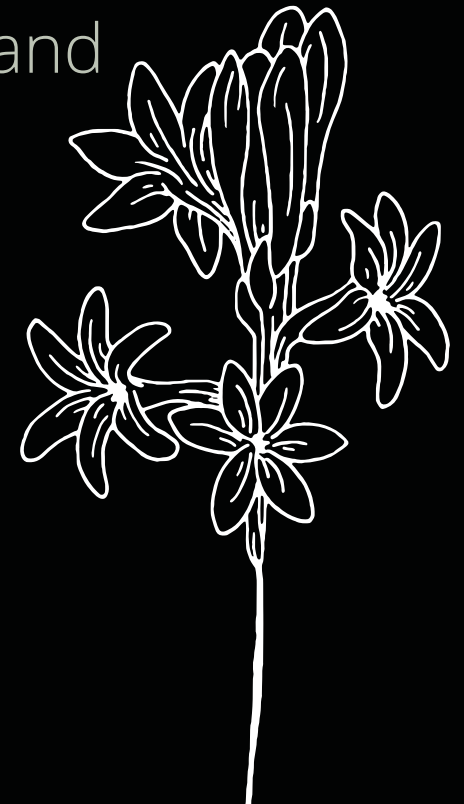

# Floor Plans



TYPE & NAME	CARPET
904, 1004	829 sqft



# Floor Plans



TYPE & NAME	CARPET
302	847 sqft



# Floor Plans



TYPE & NAME	CARPET
502, 602	793 sqft



# Floor Plans



TYPE & NAME	CARPET
1002	1094 sqft



Smt. Ravi  
Society



# Floor Plans

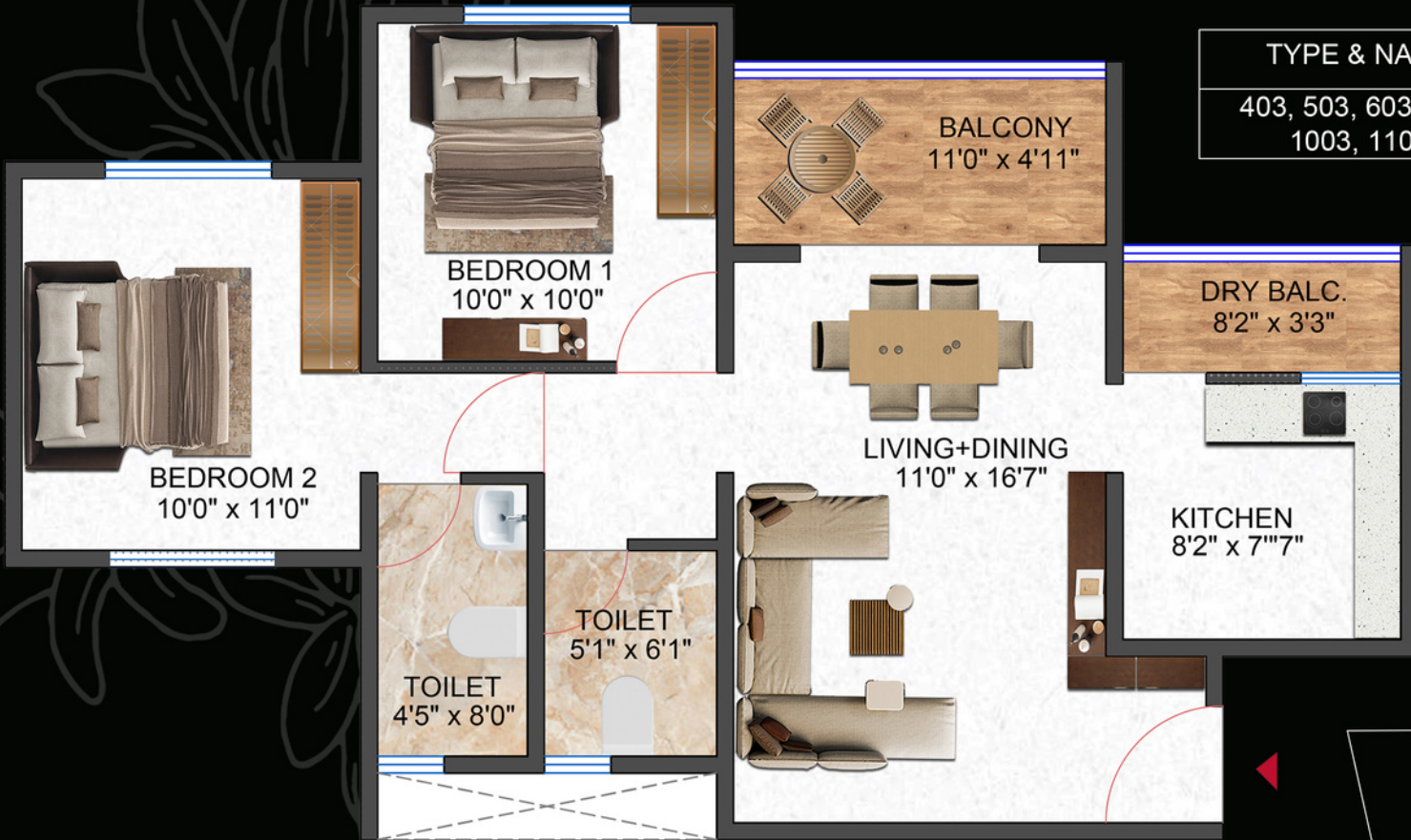

TYPE & NAME	CARPET
403, 503, 603, 703, 1003, 1103	847



MARSAHA  
MAYCHA

SHRI RAM  
SOCIETY

ROAD

# Floor Plans

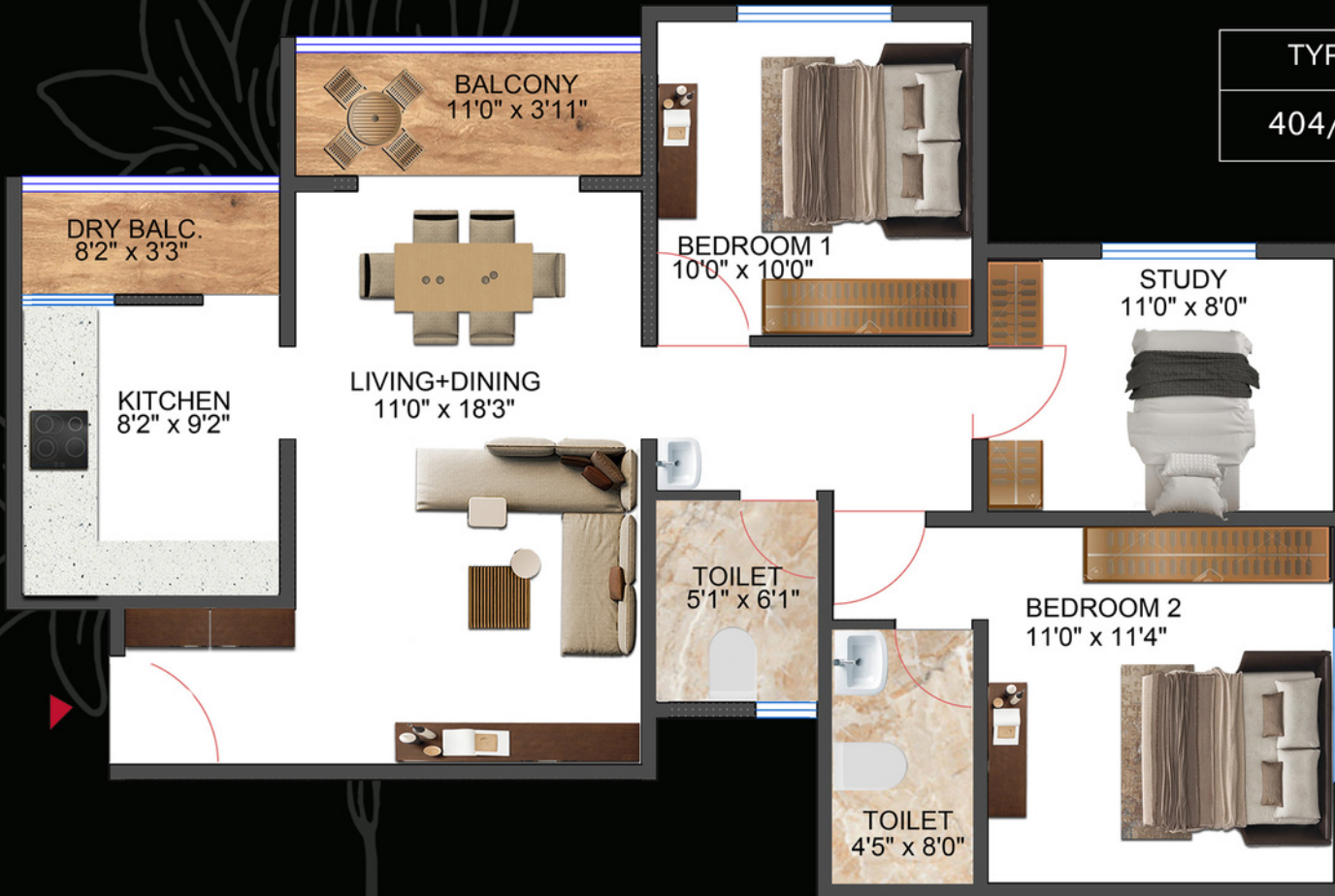

TYPE & NAME	CARPET
404/ 904, 1004	701/ 831 sqft



# Amenities & specifications

## Individual Flat Features

- Video door phones
- Solar connection in Master bathroom
- Grill for windows with mosquito mesh
- Branded CP and Sanitary fittings
- Electrical switches of branded make
- Provision for inverter
- Maindoor and internal door with laminate on both sides with branded locks.
- Rainwater Harvesting
- Fire fighting system
- CCTV Camera coverage for common areas
- Decorative designed name plates at entrance lobby
- Elegant Entrance lobby
- Multi level parking
- Generator backup for common utility and lifts
- Modern Lift

## Internal Specifications

### Walls

- 6" thick external , 4" thick internal walls
- Neeru finished quality internal plaster
- Sand faced plaster externally

### Electrical

- Concealed electrical points
- TV/telephone points in living and master bedroom
- AC point in master bedroom and living room
- Exhaust fan points in kitchen and toilets

### Painting

- Apex paint externally and luster internally

### Flooring

- Vitrified flooring in all rooms
- Black granite kitchen top with SS sink of branded make.
- Anti-skid flooring in terrace and toilets.



# Location

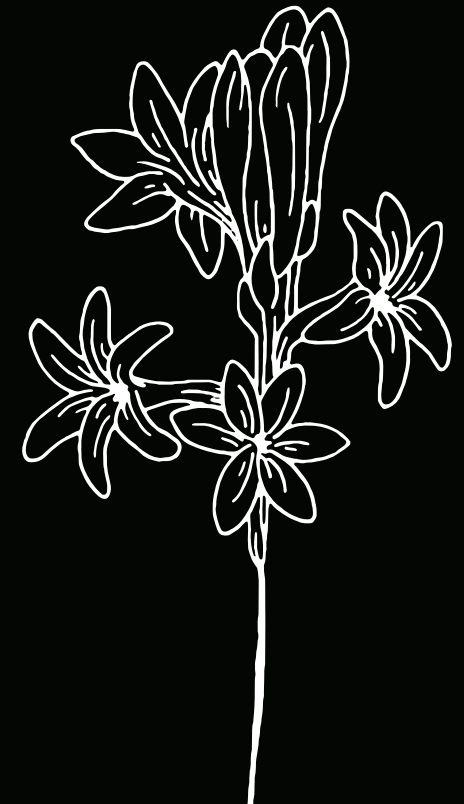

Site address: 32, Navketan No.2 Galli, Mahaganesh Colony, Kothrud, Pune, Maharashtra 411038

# Our Projects

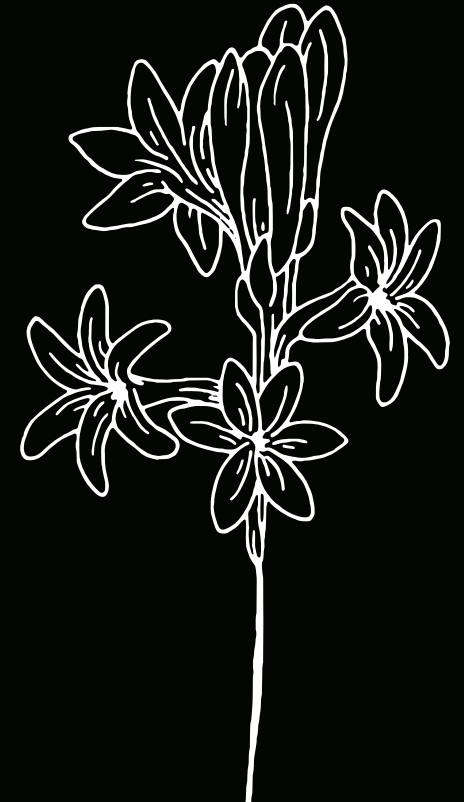

*Lets Talk*

## SALES OFFICE ADDRESS

"Devashish" Bungalow, S. No. 43, Near Navsahyadri post office, Karve Nagar, Pune- 52

## CONTACT US AT:

+91 8421300229

## EMAIL US

[associated.recons@gmail.com](mailto:associated.recons@gmail.com)

CREDITS  
Architects  
A design studio

RCC consultant  
JRCC

